

ASSEMBLY INSTRUCTIONS TECHNIBIKE

E-CITY/E-TREKKING/E-MTB

City bike/trekking bike/ATB/MTB DIN EN ISO 4210:2014 Pedelec/E-Bike DIN EN ISO 15194

ENGLISH



TECHNIBIKE

Introduction

Dear Customer,
Your Pedelec has been carefully pre-assembled in the factory. For easier transport, some parts have been loosened and put in transport position. In order to get the Pedelec ready and safe to ride, these parts must be put into a normal position and fastened after the Pedelec is unpacked.



Let a specialist perform these work-steps. They are relevant for your safety.

However, the resulting costs are not born by the manufacturer!

If you would like to do this work yourself, be sure to read these instructions carefully and keep it safe. Follow all of the steps it describes.



Let a specialist dealer install the following parts correctly: lighting equipment, all reflectors, the bell, protectors for chainring and spokes. Without those parts your pedelec does not conform to German legal requirements and applicable standards. Only fully equipped it is legal to ride on public roads in Germany and many other countries. Inform yourself about the applicable laws in your country and region.

These assembly instructions are applicable only together with the included operating instructions. Page numbers refer to the pages of the original operating instructions.

Safety Instructions

This operating manual contains five different types of pointers – one providing important information about your new Pedelec and how to use it, a second referring to possible damage to property and the environment, and a third type warning against potential falls and serious damage, including physical injury. The fourth pointer prompts you to apply the proper torque so the parts don't loosen or break. The fifth pointer reminds you that it is necessary to study the operation and installation manuals included carefully. When you see these symbols, there is always a risk that the described danger may occur. The text which the warning covers always has a grey background. The warnings break down as follows:



Note

This symbol provides information about how to use the product or highlights specific parts of the operating instructions that are particularly important.



Attention

This symbol warns of misuse which could result in damaging the product or the environment.



Danger

This symbol indicates possible dangers to your health and life that could arise if specific actions or appropriate care is not taken.



Important bolted connection

Precise torque must be applied here when tightening. The correct mounting torque is either displayed on the component or listed in the table of torques in the chapter on bolted connections. In order to apply a precise torque, you must use a torque wrench. If you don't have a torque wrench, refer this work to a specialist dealer! Parts which do not have the correct torque could fall off or break! This may result in severe falls.



Operating instructions

Read all of the instruction manuals delivered with the bicycle. If you are unsure about any of the topics addressed in this handbook, contact your specialist dealer or service partner.



Modern Pedelec technology is high-tech! Working on bicycle parts therefore requires expert knowledge, experience and specialist tools! Do not work on your Pedelec by yourself. Take your Pedelec to a specialist workshop if it is in need of repair, maintenance or restoration.

Intended Use



Not every Pedelec can be used everywhere and for every purpose. Before riding, be sure to read the information in the "Intended Use" section of the original operating instructions. If you are not clear about what type of Pedelec you have and how it should be used, contact your specialist dealer **or service partner**.

Unpacking the Pedelec

The Pedelec is shipped in a special closed shipping carton. Find a suitable space for performing the assembly.



The vehicle has had lubricants applied at various locations. Always wear appropriate clothing and personal protective equipment, such as suitable gloves, when assembling.



The carton may be heavy.

1. Place the shipping carton upright on its bottom side. **This side can be found using the printing on the cartons.** Then open it on the top.



Be careful; metal staples may have been used to close the carton. Take care not to injure yourself on these staples.

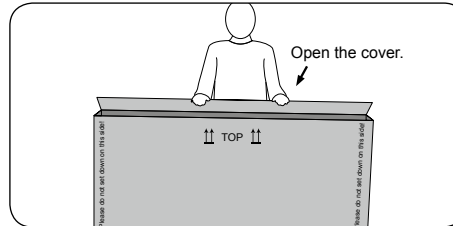

The shipping carton also contains boxes of accessories containing:

- pedals with reflectors mounted
- lighting system in accordance with the German laws
- bell
- spoke reflectors
- protectors for chainrings and spokes
- charging device for the battery
- all manuals

2. Lift the Pedelec and the box of accessories carefully out of the shipping carton.



The vehicle may be heavy. Get help from another person.

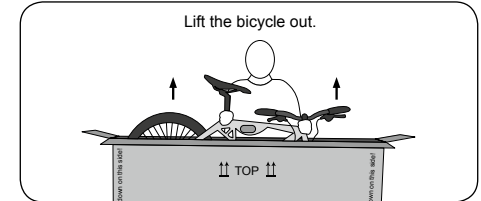

3. Check if your Pedelec has been damaged in transport.



Dispose of the packaging material properly and according to regulations at an appropriate disposal site.

Operating Quick Releases and Quick Release Axles

Quick releases are systems used in place of bolted connections to attach parts to the Pedelec. They consist of two parts: the clamping lever, which provides the necessary clamping force, and the locking nut, which allows you to regulate the clamping force. You can change the setup of your quick release when the clamping lever is open.



Quick releases should be closed with the correct holding force. To close the lever correctly, pressure should be felt when it is half closed and, at the end, the ball of the thumb needs to be used to completely close it.

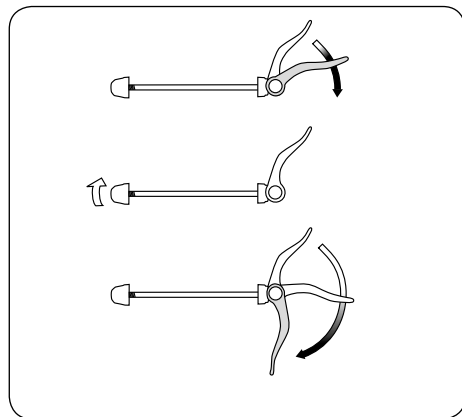

Loosening the adjusting nut

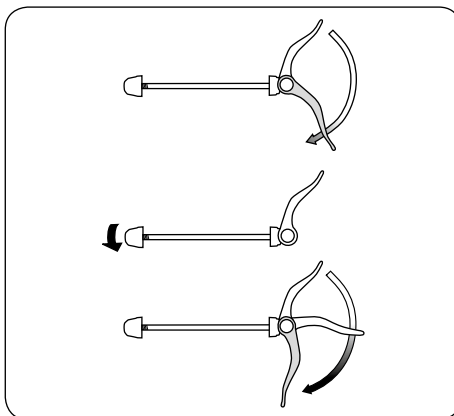

Tightening the adjusting nut



- All quick releases and quick release axles must be firmly closed before you set off.
- Make sure all quick releases and quick release axles are securely and properly fastened - even if the Pedelec has only been left unattended for a short time.
- A closed quick release fastener must be folded close to the frame, fork or seat post.
- In a closed state, the tip of the quick release lever must always be pointed backwards. This way, the quick release won't open during the ride.



Secure wheels or other parts of your Pedelec that are attached with quick releases when you park your bicycle.

In current chassis, quick release axles may be used in place of quick releases or bolts. These usually function like quick releases and must be operated as such.

The axle is attached or screwed into the dropout and holds the hub between the two dropouts. The hub and the axle may be fastened with a quick release lever, which is operated just like a normal quick release. Systems in which the axle is only inserted or screwed in and then fastened with a screw also exist.

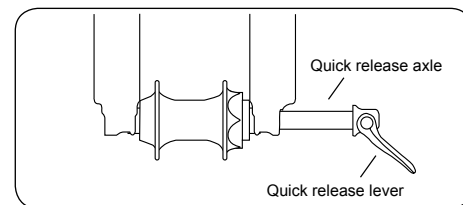

Please read the enclosed instructions of the parts manufacturer on this topic and contact **your specialist dealer or service partner** should you have questions regarding the system.

Adjusting the Saddle Height



To adjust the saddle and seat position correctly and safely, please refer to the information in the original operating instructions which can be found in the chapter "Adjusting the bicycle to the rider".

The seat post has been folded for transport. Open the quick release **or loosen the Allen key on the seat post clamp** and pull the seat post into the suitable position.

Please note that the saddles of Pedelecs that are equipped with a hydraulic or spring-operated seat post may sink a little after you have mounted them. This changes the seat position.

Once you have found a suitable seat position, close the quick release **again or tighten the screw of the seat post clamp again**.

The seat post has a minimum lowering depth that can be found at the bottom end of the seat post. If it is exceeded, there is risk of breakage.

Assembly



After assembly and adjustments are complete, be sure to check that all screw connections and fasteners are securely fixed. 

The vehicle has had lubricants applied at various locations. Always wear appropriate clothing and personal protective equipment, such as suitable gloves, when assembling.

Assembling the Pedals

The pedals are marked "L" for "left" and "R" for "right". Turn the right pedal into the crank arm on the chainring side and the left pedal on the opposite side.

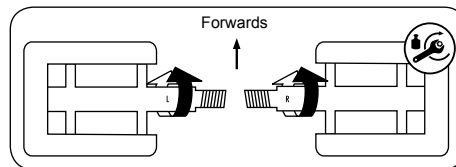
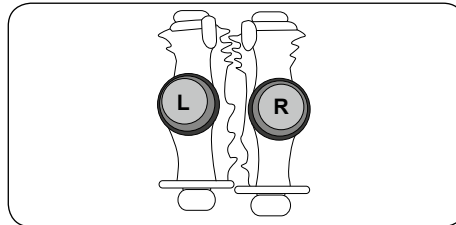

Apply assembly grease to both threads before installing the pedals.



Note that the right pedal must be turned clockwise, while the left pedal must be turned counterclockwise. To do this, use an open-end wrench, an Allen key or a special long pedal wrench. The appropriate tightening  torque is 40 Nm.



If the pedals are mixed up or cross-threaded, the threads will be damaged. The pedals could break off from the crank, which can lead to a crash and severe injuries.

A-Head Stem

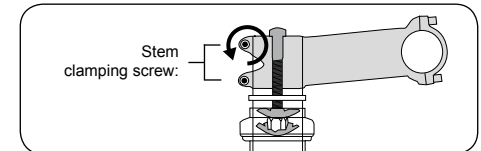

1. Loosen the stem clamping screw of the stem with a 5 mm hex key, turning counter-clockwise. Back it out only a few turns.

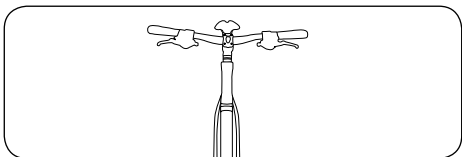

- Align the stem so that the handlebars are at exactly a 90 degree angle, perpendicular to the front wheel.

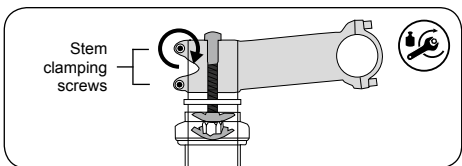

- Now use a torque wrench to tighten the stem clamping screws clockwise.



An A-head stem must be tightened to 6–8 Nm. If a different tightening torque is marked on the component, use that torque instead.

Adjustable A-Head Stem

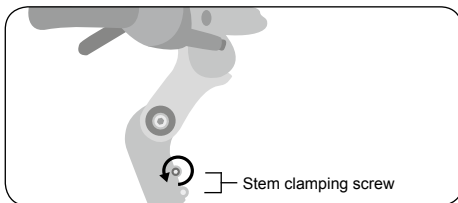

- Loosen the stem clamping screw on the bottom of the stem with a 5 mm hex key, turning counter-clockwise. Back it out only a few turns.

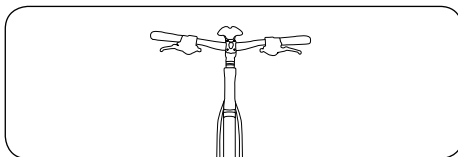

- Align the stem so that the handlebars are at exactly a 90 degree angle, perpendicular to the front wheel.

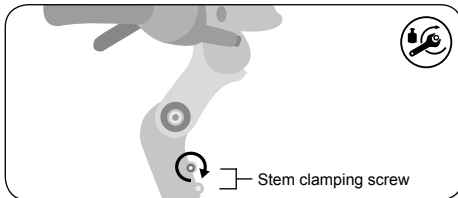

- Now use a torque wrench to tighten the stem clamping screws clockwise.



An A-head stem must be tightened to 10–12 Nm. If a different tightening torque is marked on the component, use that torque instead.

Information on adjusting an adjustable stem can be found in the chapter “Adjusting the bicycle to the rider” and possibly also in the enclosed instructions of the parts manufacturer.

Brake Levers

Set up your brake levers in such a way that you can safely apply them and brake comfortably.



The brake levers should be set up so that your hands can apply them as a straight extension of your arms.

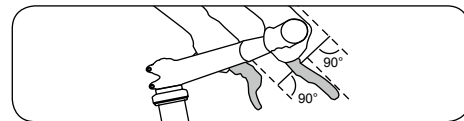

Once the brake levers are in a position which suits you, first tighten the top screw ① of the clam bracket of the brake lever to 4Nm. Then tighten the lower screw ② to 4Nm as well.

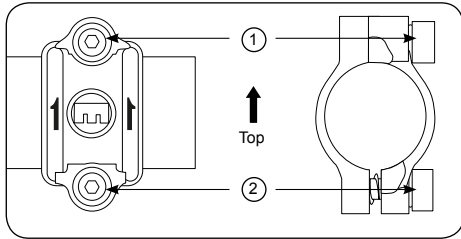

The distance to the handlebars can be adjusted with an adjusting screw (in the levers) so that the brake levers can be safely operated by hands of differing sizes.

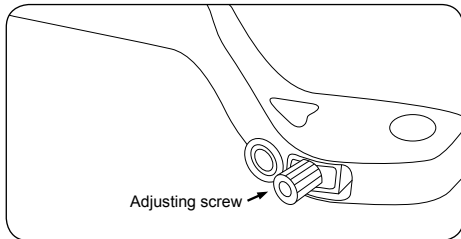

Inserting the Battery

i The operating instructions of the drive system from Continental are enclosed with your Pedelec. To insert the battery, follow the instructions in this manual.

Testing



Perform the following test before the first ride: Lift your Pedelec up slightly and drop it onto the ground from about 10 cm in the air. If you hear rattling or other unusual noises, check all bolted connections. If rattling or unusual noises persist even after you have checked, have a **specialist dealer or service partner** determine and remove the cause before you set off.

Now perform the check from the section “Before your first ride” in the original operating instructions.

Important information!

Dangers of improper use



Only use your bike or Pedelec for its intended use. Please read the section “Intended Use” in the original instruction manual. This also includes adherence to the operating, servicing and maintenance conditions that are described in this manual. Inform other users of the intended use and the dangers of not adhering to it. Improper use, overloading and lack of maintenance may lead to accidents and falls involving severe injuries to you and other people!

Snagging hazard



Moving and turning parts of your Pedelec may lead to danger during use, maintenance and upkeep. Protect yourself by not wearing loose clothes that may get caught. During use, maintenance and upkeep, stay away from turning parts (wheels, brake discs, cassettes). Do not touch moving, sharp or protruding parts (chains, pedals).

Legal information

TechniBike GmbH

Julius-Saxler-Straße 3, TechniPark

D-54550 Daun / Germany

Fax +49 6592 712 8219

Contact: info@technibike.de

Website: www.technibike.de

Management: Peter Lepper,
Marc A. Prüm, Claudia Thelen

Responsible for distributing and marketing the operating instructions

inMotion mar.com, Rosensteinstr. 22,

D-70191 Stuttgart / Germany

Tel. +49 711 35164091, Fax +49 711

35164099

info@inmotionmar.com, www.inmotionmar.com

Content and images

Veidt-Anleitungen, Friedrich-Ebert-Straße 32

D-65239 Hochheim / Germany

Veidt-Anleitungen@email.de

Legal inspection by a lawyer's office specialising in intellectual property.

This operating manual covers the requirements and scope of ISO 4210:2014 and EN 15194.

In case of delivery and use outside this scope, the manufacturer of the vehicle must supply the requisite manuals.

© Before reproducing, reprinting, translating or using this document for any economic purpose (even in part, printed or electronic form), you must first receive written consent.

TechniBike Installation Version 1.0 January 2018